

Rough Terrain Truck **RP** series

- ◆ Great equipment to move heavy loads up to 1250kg.
- ◆ Ergonomic design of the frame to reduce the operation effort.
- ◆ Robust enough for the purpose to work outside such as building yard, garden centers.
- ◆ Adjustable fork for special dimension pallet.

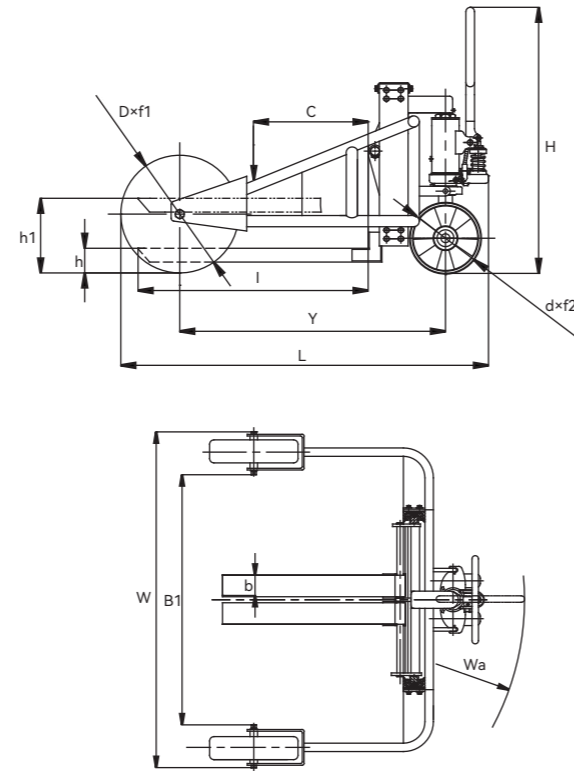

RP1250A



RP1250B



Model		RP1000A	RP1250A	RP1250B
Rated Capacity	(kg)	1000	1250	1200
Max. / Min. Fork Height	h1/h (mm)	240/70	240/70	233/63
Fork Length	I (mm)	800(860)	800(860)	860
Load Center	C (mm)	400(430)	400(430)	450
Adjustable Fork Width	(mm)	216~680	256~680	228~735
Individual Fork Width	b (mm)	100	120	-
Distance Inside The Front Wheel	B1 (mm)	1230	1230	1277
Axle Distance Between Front Wheel And Rear Steering Wheel	Y (mm)	973	973	-
Front Load Wheel	Dia. xW (mm)	Ø568x145	Ø568x145	550x132
Rear Steering Wheel	Dia. xW (mm)	Ø250	Ø250	255x80
Turn Radius	Wa (mm)	1500	1500	-
Overall Size	L x W x H (mm)	1406x1670x1280	1406x1670x1280	1375x1605x1200
Net Weight	(kg)	210	238	225

Mechanic Lifter **MR200** series

- ◆ For moving and transporting display pallets, fruit pallet, etc.
- ◆ Large wheels of polyurethane ensuring an excellent manoeuvrability.

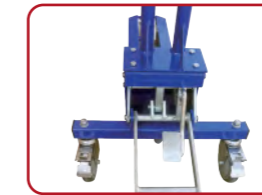

Galvanized



Model		MR200	MR200-A	MR200-B
Capacity	(kg)		200	
Max. / Min. Platform Height	(mm)		120/95	
Front Wheel	Dia. xW (mm)		Ø75x32	
Rear Castor	Dia. xW (mm)		Ø125x32	
Fork Size	L x W (mm)	580x210	600x190	750x190
Platform Size	(mm)	215x575	190x600	190x750
Overall Size	(mm)	920x510x1040	940x510x1040	1090x510x1040
Net Weight	(kg)	21	24	26