

## Counter Balance Stacker FX / FR series

- ◆ The non-straddle lift is ideal for feeding machinery or lifting to docks and mezzanines where base legs could interfere.
- ◆ Heavy-duty mast can be adjusted to suitable degree.
- ◆ Forged fork for easy access.
- ◆ Powerful drive and power unit made in Europe.
- ◆ Top quality electronic control system from Curtis.
- ◆ Conforms to EN 1757-1, EN1726.

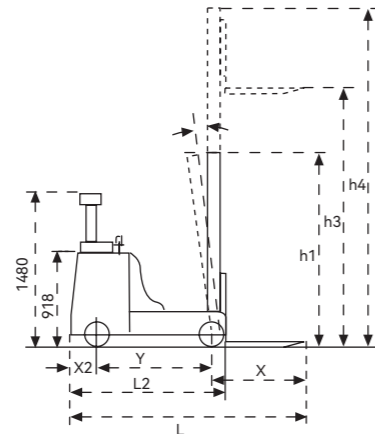

FX1025

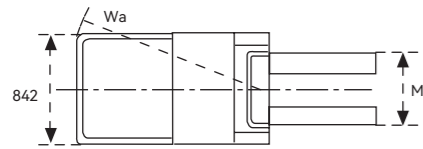

Model	FX1025	FR1025	FR1033	FR1525	FR1533
Capacity	(kg) 1000	1000	1000	1500	1500
Load Center	(mm) 400	500	500	500	500
Fork Size	(mm) 900×100×35	900×100×35	900×100×35	900×100×35	900×100×35
Fork Outer Width	(mm) 220-540	230-670	230-670	230-670	230-670
Fork Rake	(mm) 550	550	550	550	550
Lifting Height	(mm) 2500	2500	3300	2500	3300
Max. Working Height	(mm) 3431	3431	4231	3431	4231
Lifting Height	(mm) 140	200	200	200	200
Fork Inclination Angle	(°) 1/7	3/5	3/5	3/5	3/5
Mini. Ground Clearance	(mm) 60	60	60	60	60
Turning Radius	(mm) 1350	1485	1485	1485	1485
Driving Speed (Full Load / No Load)	(Km/h) 5.7/6.3	7.1/7.9	7.1/7.9	7.1/7.9	7.1/7.9
Lifting Speed (Full Load / No Load)	(mm/s) 100/140	98/132	98/132	98/132	98/132
Lowering Speed (Full Load / No Load)	(mm/s) 181/175	191/157	191/157	191/157	191/157
Braking Method	Electromagnetic				
Driving Motor	(KW) 2				
Lifting Motor	(KW) 2				
Battery	(Ah/V) 240/24				
Overall Length	(mm) 1900				
Overall Width	(mm) 1000				
Overall Height	(mm) 1840	1840	2240	1840	2240
Battery Weight	(kg) 1515	235	235	235	235
Net Weight (Without Battery)	(kg) 1201	1201	1251	1358	1408

## Counter Balance Truck CPD15SB

### Characters

- ◆ Electric powered steering, AC motor, vertical driving unit.
- ◆ Three fulcrum type, compact structure, small steering radius. Suitable for operating at aisles and upstairs.
- ◆ Also named pallet stacker without legs, fitted for all pallets.
- ◆ Smooth double lift cylinders and masts with open eyeview.
- ◆ Imported electric controller and hydraulic power unit, core encapsulating PU wheels.
- ◆ Easy to maintenance or repair, standing platform optional.



Model	CPD15SB	
Load Capacity	Q (kg)	1500
Load Center	C (mm)	450
Overall Length	L1 (mm)	2535
Overall Width	W (mm)	950
Min. Overall Height	H1 (mm)	2050
Height of Handle	H2 (mm)	1160 - 1445
Dimension of Forks	L×b×m (mm)	920×100×35
Outside Width of Forks	D (mm)	240 - 580
Ground Clearance, Chassis	m1 (mm)	90
Ground Clearance, Masts	m2 (mm)	70
Base Distance	LO (mm)	1250
Wheel Material		PU
Front Wheel Size	(mm)	Ø200×80
Driving Wheel Size	(mm)	Ø230×80
Balance Wheel Size	(mm)	Ø125×50
Min. Steering Radius	Wa (mm)	1480
Width of Aisle	1000X1200 pallet (mm)	2970
	800X1200 Pallet (mm)	3080
Lifting Height	H (mm)	3000/4500
Max. Overall Height	H3 (mm)	3860/5360
Mast Tilt Angle	forward α (°)	2
	Backward β (°)	5
Max. Travelling Speed	(Km/h)	6.0
Lifting Speed (laden / unladen)	(mm/s)	100/135
Lowering Speed (laden / unladen)	(mm/s)	325/220
Gradeability (Laden)	(%)	8
Brake Type		Electromagnetic
Power of Driving Motor	(Kw)	1.5
Power of Lift Motor	(Kw)	3.0
Battery Capacity / Voltage	(Ah/V)	240/24
Weight of Battery	(kg)	240
Net Weight (without battery)	(kg)	1580/1740

