

Drum Lifter **DL500F** series

- ◆ Lifting, moving and stowing 30 gallon and 55 gallon drums.
- ◆ Works easily with overhead hoist or hook from forklift or crane.
- ◆ Compact and heavy duty design, convenient to use.

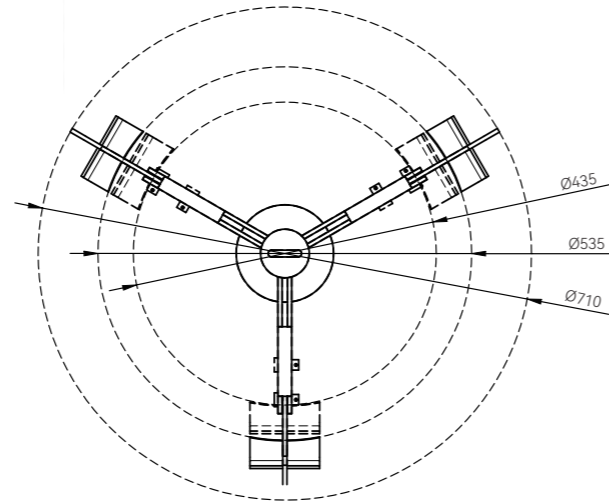
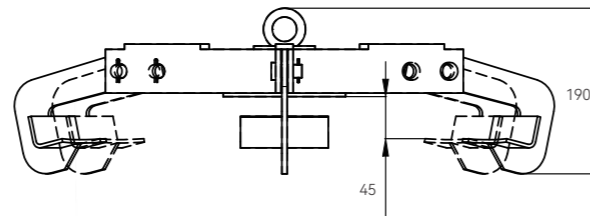

Model		DL500F
Load Capacity	(lbs)	1000
Drum Type Lifted		33 gallon and 55 gallon, closed-head steel & poly drums
Net Weight	(lbs)	30
Overall Dimension	H×W×D (inch)	5½ × 29½ × 29½

Vertical Drum Lifters / Dispensers **LM / LG**

- ◆ One-person Operation saves time, reduces spilling waste, and improves productivity.
- ◆ Simply attach or hang lifter on hook from an overhead hoist or crane, cinch saddle around drum, and raise to desired height and position.
- ◆ Lift, transport, and pour from open and closed head drum.

LM800N

- ◆ Positive tilt lock on drum saddle to hold drum upright in transit.
- ◆ When released, the operator can manually tilt the drum to control pouring as the drum can be rotated 360° in either direction.
- ◆ Locks also hold drum in horizontal position.



LG800

- ◆ Allows remote pouring operations.
- ◆ Geared chain control and low effort feature make this model useable at any height. 10-ft control chain can be locked to secure drum in any position during transit and dispensing.



Special web sling as option.



Model		LM800	LG800
Max. Weight Capacity	(kg/lbs)	360 / 800	
Drum Type Lifted		30/55 gallon closed-head steel drum	
Net Weight	(kg/lbs)	20 / 44	38 / 84
Overall Dimension(H×W×D)	(mm/inch)	990×725×200 / 39×28½×85	