

Hydraulic Drum Truck DT series



Model	DT300	DT350A	DT350B	DT350C	DT400C
Capacity (kg)	300	350	350	350	400
Lifting Height (mm)	280	300	300	300	300
Max. Width (mm)	1100	920	1260	1400	Adjustable, Max. 1550
PU Wheel Front/Rear (mm)	Ø125×50/Ø125×50	Ø150×50/Ø125×50	Ø150×50/Ø125×50	Ø150×50/Ø125×50	Ø200×50/Ø200×50
Net Weight (kg)	67	50	50	55	109

Ergonomic Drum Lift Truck DT400

- Heavy-Duty
- ◆ Ergonomic lifts, transport, and places poly, steel, or fiber drums on or off pallets.
 - ◆ A spring-load clamp securely holds any rimmed drum.
 - ◆ It has swivel steering wheels for easy positioning and precision roller bearing load wheels for maximum stability.
 - ◆ Legs adjust for different pallet, Handles 55-, 85-gallon drums.

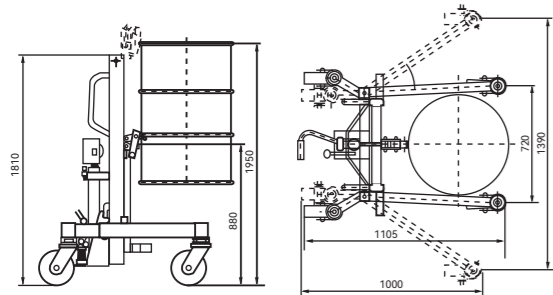

Model	DT400	DT400A
Lifting Capacity (kg)	400	400
Lifting Height (mm)	1100	1500
Max. Width (mm)	1380	900
Drum Size	210L (55 gallon), Dia. 572mm (22 1/2")	
Net Weight (kg)	100	135

Raptor Drum Load/Unloader DTF series

- ◆ Easily glides over pallet to quickly load or unload 30 or 55-gallon drums, Grabs drums from the middle of a standard pallet with a drum clawgrab, raises the drums up, and redistributes them throughout the facility.
- ◆ Also removes drums from the corner of containment skids, Highly maneuverable unit features a unique two poly wheel and two poly caster.
- ◆ Both steel drum and plastic drum.

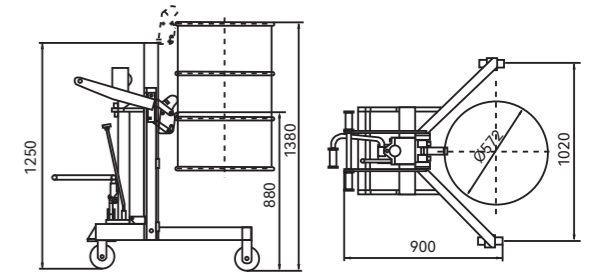

Model	DTF450	DTF450A	DTF450C	DTF500N(Adjustable-leg)
Lifting Capacity (kg)	450	450	450	450
Lifting Height (mm)	500	600	1100	500
Max. Width (mm)	1020	880	1150	1170
Drum Size	210L (55 gallon), Dia. 572mm (22.5")			210L (55 gallon) / 320L (85 gallon)
Net Weight (kg)	145	125	155	110

Hydraulic Drum Truck DTW250

- Straddle leg
- ◆ Ideal for lifting and transporting steel drums with a top lip.
 - ◆ Straddle leg for picking up drum from a Euro Pallet.
 - ◆ Spring-loaded steel jaws securely grip the top lip of the drum.
 - ◆ Simple design is easy to use; unit features a manual mechanical hand ratchet crank lift mechanism.
 - ◆ Includes two rigid and one locking swivel caster.

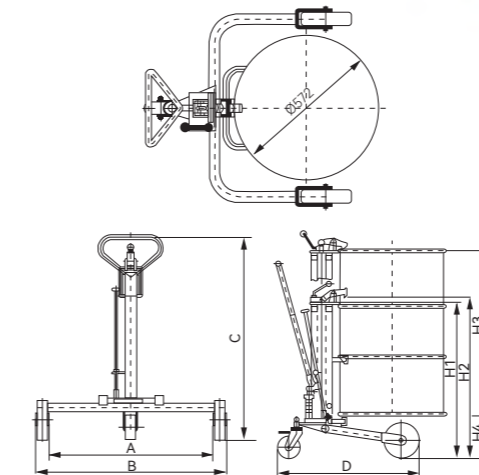

Model	DT250	DTR250	DTW250
Lifting Capacity (kg/lbs)	250 / 550	250 / 550	250 / 550
Lifting Height (mm/inch)	345 / 13 9/16	1180 / 46 7/16	345 / 13 9/16
Lifting Per Stroke (mm/inch)	22 / 7/8	22 / 7/8	22 / 7/8
Drum Size	572mm (22 1/2" Diameter), 210Lifters (55 gallon)		
Dimension	A (mm)	670	850
	B (mm)	800	950
	C (mm)	1050	1050
	D (mm)	820	812
H1 (mm)	875	880	875
H2 (mm)	908	910	905
H3 (mm)	900	900	900
H4 (mm)	320	380	320
Net Weight (kg/lbs)	42/93	50/110	45/99

添加一个新产品, DTK450S/参数同DTF500N